



ACJT105-8V 1A TRIAC

Rev.A.1.1

DESCRIPTION:

6. (r)7<0107> <κ-0.202 Tc [(s).7 -1P <</MC5D 1 >>BDCJ 028004 Tc -4.74TjEWC VP <</10.076
T T1 -8V (i)2 (n (h e . 0 ee

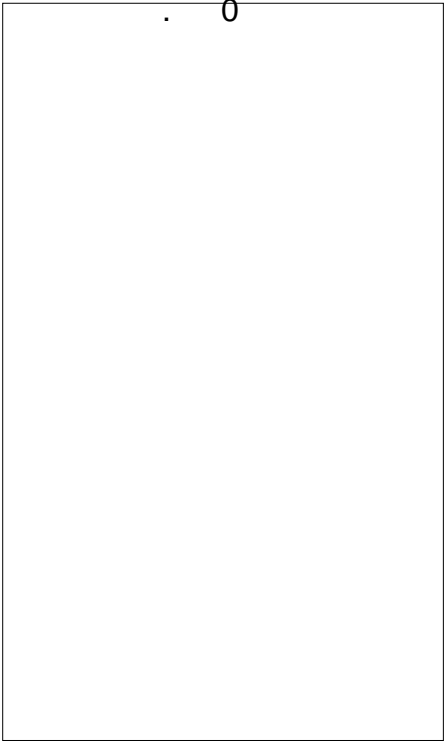

ACJT105-8V

P ($T_F=25$; non -at e8)	V	3.5	kV
----------------------------------	---	-----	----

ELECTRICAL CHARACTERISTICS (T_F=25 °C)

Symbol	Test Condition	Quadrant	Value	Unit
I_{G_T}	$V_D=12V R_L=33$			

ORIGINAL INFORMATION

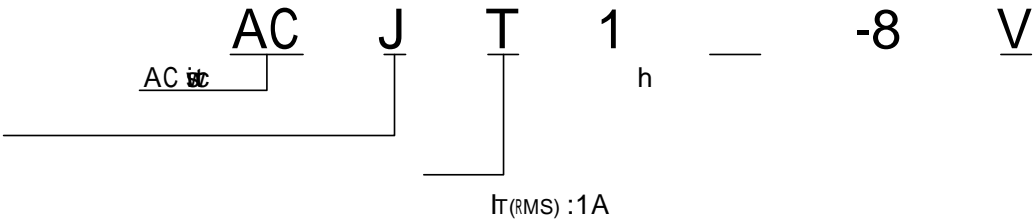

FIG.1: Maximum on-state current vs. junction temperature
FIG.2: RMS on-state current vs. junction temperature

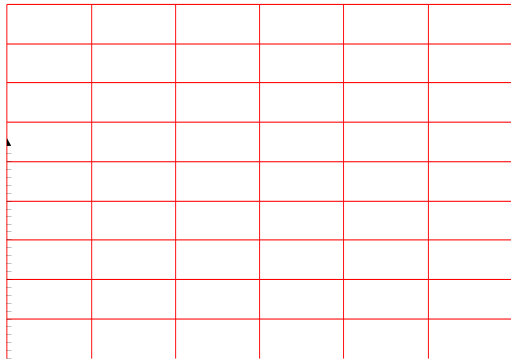

FIG.7: R

e h
e

latv
m

e
olding cu
e

ariatonsof gat
e
ratu

ORDER INFORMATION

Order code	Voltage V_{DRM}/V_{RRM} (V)	IGT(mA)	Package	Base qty. (pcs)	Delivery mode
ACJT105-8V	800	5	SOT-223	4,000	Tape & Reel

Document Revision History

Date	Revision	Change Description
Apr. 13, 2013	A.1.	Initial release
Oct. 23, 2013		

PACKAGE MECHANICAL DATA

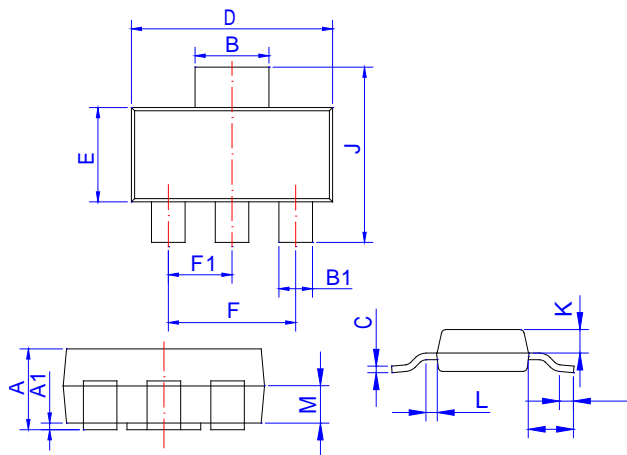

R	Dim e					
	Millime			Mic		
	Min.	Ty	Max	Min.	Ty	Max
A	1.5	1.6	1.8			
A1						
B	2.9	3.	3.1			
B1						
C						
D	6.3	6.5	6.7			
E	3.3	3.5	3.7			
F	4.4		4.8			
F1	2.2		2.4			
G			1.			
	1.5	1.75	2.			
J	6.7	7.	7.3			
K			1.			
L						
M						

FOOTPRINT -ST -223 (mm)

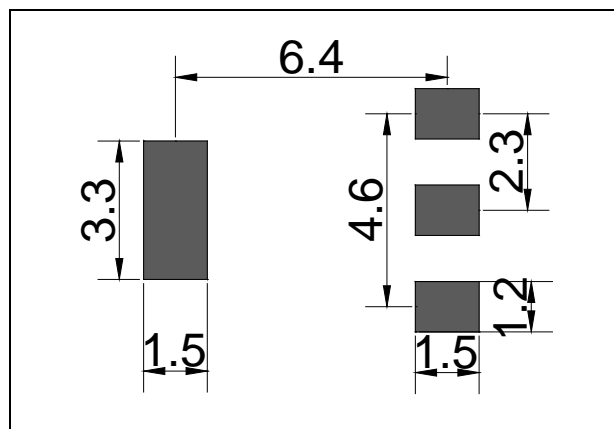

DELIVER MODE

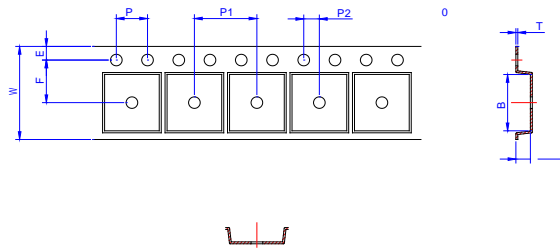

R	Dim					
	Millime			et.nc		
	Min.	Ty	Max	Min.	Ty	Max
W	-		12.3	-		
E	1.65	1.75	1.85			
F	5.45	5.5				
D		1.55	1.6			
D1		-	-			
P	3.9	4.				
P1	7.9	8.				
P2	1.95	2.				
1	39.8	4		1.567	1.575	1.583
A	6.85	6.95	7.			
B	7.15	7.25	7.35			
K	1.95	2.				
T						

